

AUCOOT



ADDRESS

Little Nook, Grange Hall, London N16

PRICE

£800,000

ARCHITECT

Nissen Richards

INFORMATION

A two-bedroom home that is part of a collection of nine houses sensitively carved out of a Victorian school building. The architects, Nissen Richards, have been careful to retain many stunning original features, creating truly inspiring spaces like the main living area. A comfortable home full of history and character.

Set over three stories, a well thought out plan puts the main living space and kitchen at the ground level of the house to make use of the courtyard garden positioned directly off the living area. The hand-built British Standard Kitchen by Plain English is handmade in their Suffolk workshop and painted on site with Little Greene's 'Obsidian Green'. The kitchen also features a 30mm thick Carrera marble worktop with oversized splash back. On the middle floor is a double bedroom and a family bathroom. The second bedroom is on the second floor and has an additional mezzanine platform. This room could easily become a study dependent on your needs. At ground level you'll also find a utility room provisioned with a purpose-made stainless-steel catering table and sink. There is secure, gated access with a video entry-phone system.

The house features lightly smoked and waxed engineered oak floors. Electric Underfloor heating to all the houses is controlled by the latest Neo E thermostats from Heatmiser. This technology incorporates self-learning preheat features to ensure the house warms up just in time for your arrival. Your phone will become an extension of your home, providing another way to see who's at the door, or operate the heating before you get home. A brochure is available with a full specification list, just ask us to send it to you.

The original West Hackney Parochial School was built in 1837 as two large halls that housed the girls' wing to the west and the boys' wing to the east. The building was later used as a church hall (when the original Robert Smirk designed church was bomb damaged in WW2), a social hall and a snooker house. Most recently, its name had been changed to Grange Hall and it was being used as a warehouse for rare transistors and electrical fittings.

Stoke Newington is a vibrant place to live and Church Street has become a destination for food lovers. There are lots of independent shops including a Whole Foods and it has a bustling high street with an abundance of cafés, restaurants, pubs and shops. A farmers' market is held every Saturday across the road from the houses in the yard of St Paul's Church. Stoke Newington High Street offers even more places to eat, drink, shop and dance. Venture a little further and you're within walking distance of Dalston and Newington Green, and Islington is a short bus ride away. The beautiful green space of Clissold Park with its large restored Georgian house and café, tennis courts, skate park and deer enclosure is close-by as is Hackney Downs in the opposite direction.

Please note that images of bedrooms and bathrooms are from 'The Folly' but are of the same spec



SERVICE CHARGE

n/a

EPC

=D



AUCOOT

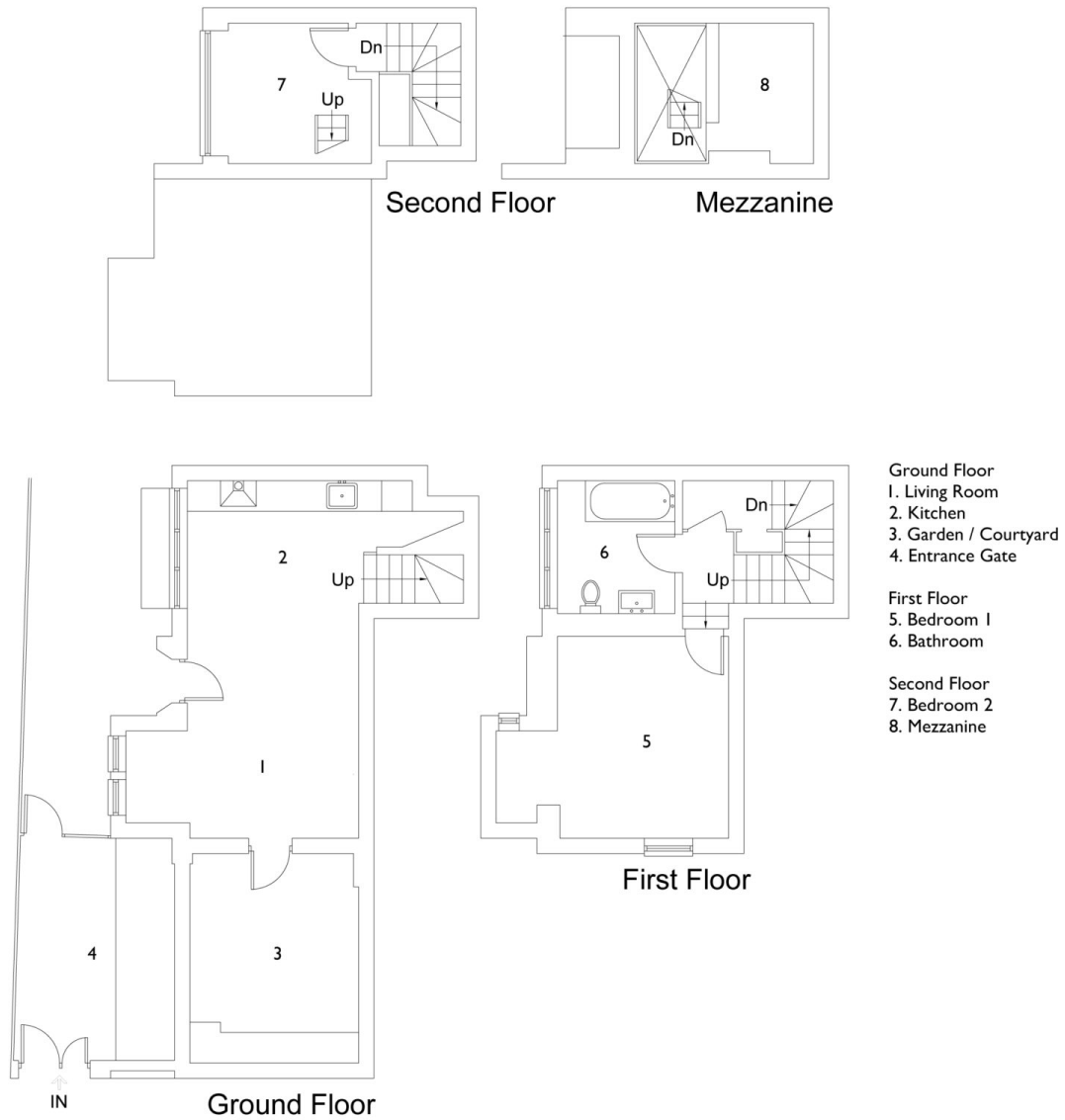

The Grange N16
 Approximate Gross Internal Area = 97.3 sq m / 1047 sq ft
 Illustration for identification purposes only. Not to scale. Ref: 188543

